

INSTRUCTION MANUAL

MANUAL

MINI COMPRESSOR AS19

Thanks for purchasing our airbrush compressor and please read this Instruction manual carefully and thoroughly before operating the tool to get best performance.

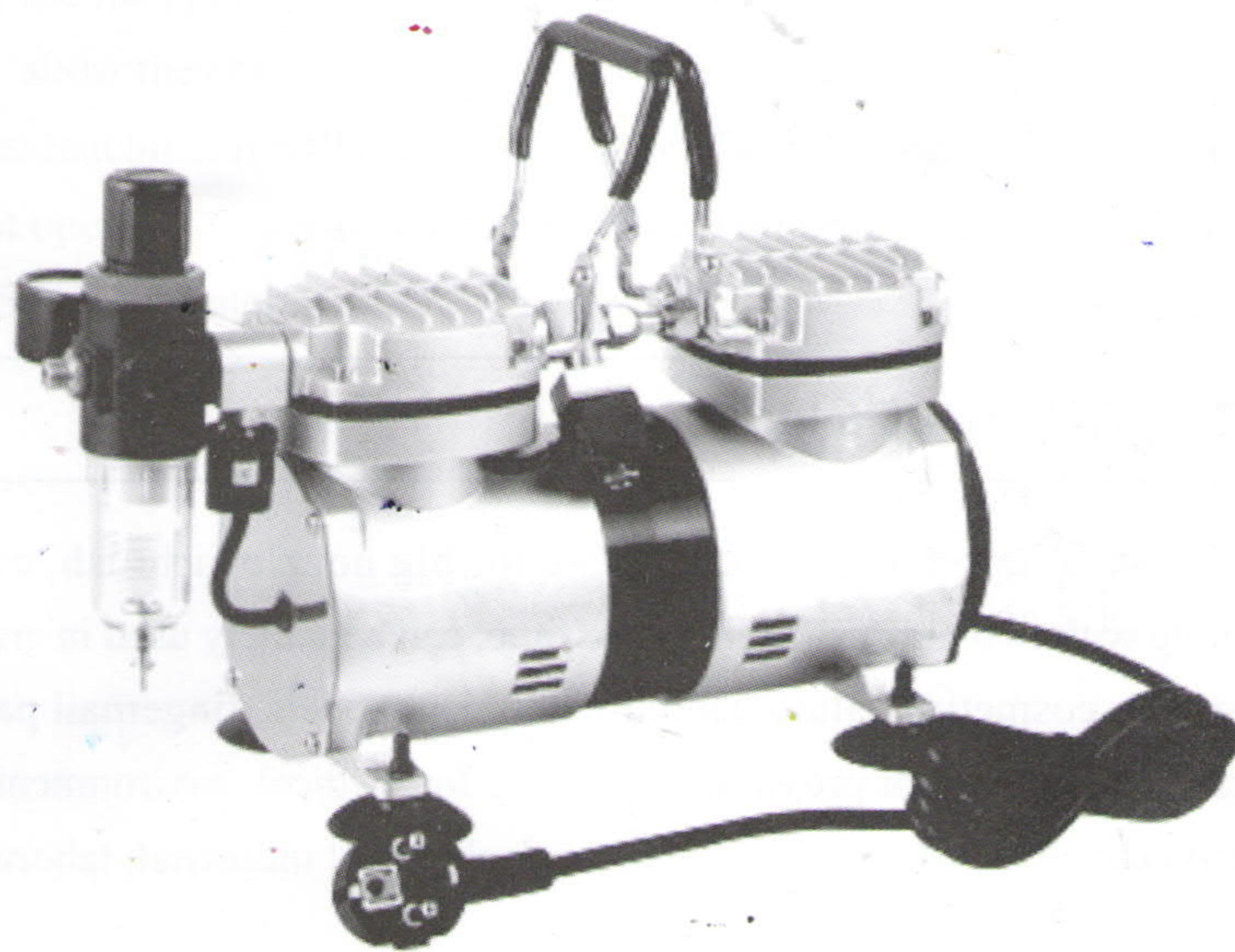

CE ROHS

1. Features:

1. Double cylinder, high air flow, can operate with many airbrushes.
2. Oil free, piston type; No air polluted.
3. With water filter, pressure adjustor and pressure gauge.
4. Double air pressure switch.
Switch 1, low pressure auto stop switch, for airbrush purpose.
Switch 2, high pressure none stop switch, for other high pressure air tools.
5. It can start with air, continuous working, powerful.
6. Thermally protected inside.
7. Low noise

2. Application Field:

Airbrush compressor AS19, suitable for big nozzle airbrush, even can operate with two airbrush at the same time, can be widely used in craftwork spraying, cosmetics, tattoo, tanning, hobbies/models, fingernail painting. It can be also used for providing air source for medical, environment protect, breed aquatics Industrial, food Industrial, chemical industrial, laboratory and so on.

5. Notice:

1. The users should choose the right air compressor with suitable air flow and pressure according to the actual work requirement.
2. Before connecting the compressor, check that the mains voltage complies with the electrical characteristics of the motor.
3. Please follow local electrical rules, and safety rules. And the use the socket which must be earthing.
4. Never leave the appliance exposed to dust, acids, vapors, explosive or flammable gasses or atmospheric agents (rain, sun, fog, snow).
5. The vacuum pump must be used in suitable environments (well-ventilated, with an ambient temperature between +5°C and +40°C)
6. Never use the appliance in your bare feet or with wet hands or feet.
7. Never allow the children to touch the working machine or insert the stick into the machine. It will cause the danger of scald or get an electric shock.
8. Do not open or tamper with any part of the compressor. Contact an authorized Service Center.

6. Spare part list:

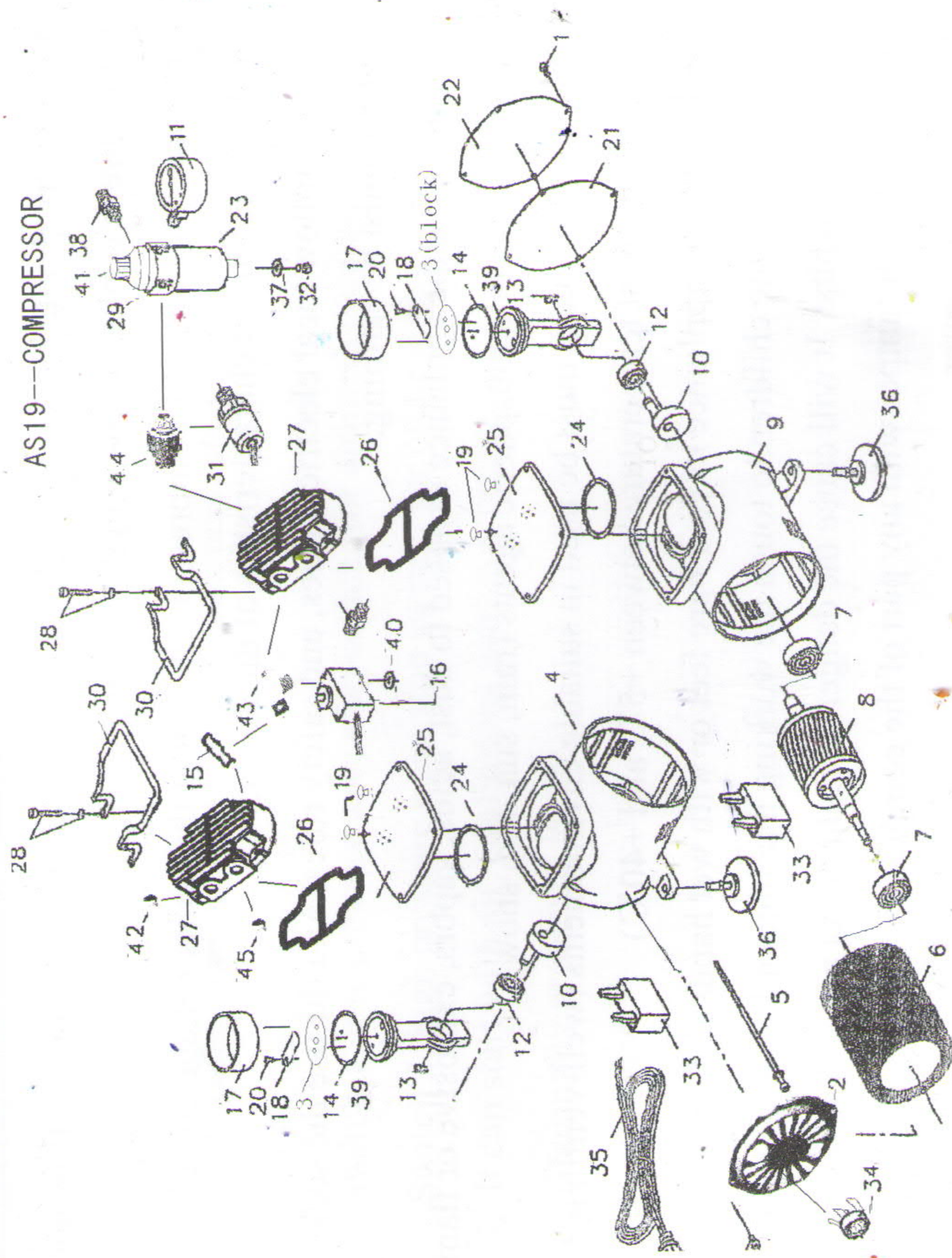

PARTS LIST

INDEX NO.	PARTS NO.	DESCRIPTION	QTY	INDEX NO.	PARTS NO.	DESCRIPTION	QTY
1	AS19--#01	SCREW	8	24	AS19--#24	O-RING	1
2	AS19--#02	REAR COVER	1	25	AS19--#25	CYLINDER BLOCK	2
3	AS19--#03	BLOCK	2	26	AS19--#26	O-RING	2
4	AS19--#04	REAR BODY	1	27	AS19--#27	CYLINDER HEAD	2
5	AS19--#05	SCREW	4	28	AS19--#28	CAP SCREW	8
6	AS19--#06	STATIONARY MOTOR	1	29	AS19--#29	FILTER VALVE	1
7	AS19--#07	BEARING	2	30	AS19--#30	HANDLE	1
8	AS19--#08	ROTARY MOTOR	1	31	AS19--#31	PRESSURE SWITCH	1
9	AS19--#09	FRONT BODY	1	32	AS19--#32	WATER DRAIN VALVE	1
10	AS19--#10	COUNTERWEIGHT	2	33	AS19--#33	CONDENSER	2
11	AS19--#11	MANOMETER	1	34	AS19--#34	POWER SWITCH	1
12	AS19--#12	BEARING	2	35	AS19--#35	WIRE	1
13	AS19--#13	RETAINER RING	2	36	AS19--#36	RUBBER PAD	4
14	AS19--#14	COMPRESSION RING	2	37	AS19--#37	HEXAGON NUT	1
15	AS19--#15	PIPE	1	38	AS19--#38	CONNECTOR	2
16	AS19--#16	SOLENOID VALVE	1	39	AS19--#39	LINK	2
17	AS19--#17	CYLINDER	2	40	AS19--#40	SCREW	1
18	AS19--#18	VALVE PLATE	2	41	AS19--#41	PRESSURE REGULATOR	1
19	AS19--#19	O-RING	4	42	AS19--#42	PLUG	1
20	AS19--#20	SCREW	2	43	AS19--#43	THREE WAY MANIFOLD	1
21	AS19--#21	FRONT GASKET	1	44	AS19--#44	NONE RETURN VALVE	1
22	AS19--#22	FRONT COVER	1	45	AS19--#45	MUFFLE	1
23	AS19--#23	FILTER	1				

3. Specification:

Type: Twin cylinder air compressor with Cover

Power: 1/4 HP

Speed: 1450/1700 r.p.m

Air output per min./liters: 35~40L/min

Double switch:

switch 1: Auto start at 3BAR(43PSI), auto stop at 4BAR(57PSI)

switch 2: Max pressure at 6BAR(86PSI), not auto stop.

Working pressure: 0~6 bar

Weight: 5.5KG

Dimension: 320X135X205mm

Suitable for all kinds of airbrushes.

4. Operation directory:

1. Usually our air compressor outlet is 1/8" BSP. If you want 1/4" BSP or other NPT screw thread, you may need other adapters fix on the outlet. Then you can connect with different air hoses.

2. The original air hose have rubber airproof inside; the user can make the airtight by hand, and get good performance. If the air hose is not the original, usually the air hose and air compressor cannot be well airproof. However, 100% airtight is only effective for auto stop function air compressor. Teflon tape can be used to prevent leakage. This elastic tape is available in all stores selling sanitary products.

3. Connect the air compressor, air hose and airbrush (or other air tools), plug into the mains supply, turn on the switch, and then the air compressor will start work. The gauge will show the max pressure, and you can adjust the working pressure by adjusting the pressure adjustor.

4. Checking the air leakage. Please do not use the air tools first, when the pressure reach the max pressure (auto stop function), for the compressor do not have auto stop function, please turn off the switch. Then check the needle of pressure gauge, if the needle on gauge is very steady, it means the airtight is very good. If the needle decline down quickly, it means there is air leakage in some place of connection. Please check and make it airtight. Or any small leakage will affect the performance of the compressor. (It may lead to frequently auto stop and auto start).

5. The difference between max pressure and working pressure. A compressor's maximum pressure is the highest pressure it can build up. When a connected airbrush is opened, it is precisely with this pressure that compressed air initially shoots out through the airbrush nozzle. In contrast, the working pressure is the constant pressure the compressor can maintain during airbrushing. The level of this working pressure depends, on the other hand, the nozzle diameter of the airbrush to which it is connected; the larger the nozzle diameter, the greater the amount of air which can escape and the lower the compressor's working pressure.

6. The bottom of the regulator & filter is the water release valve; users can open the valve to release the water or moisture at any time.

7. Air compressor structure

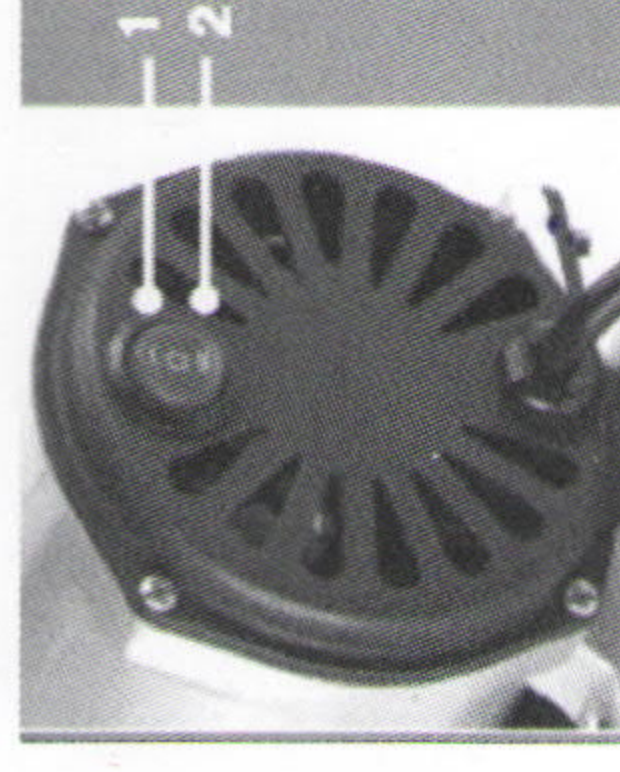
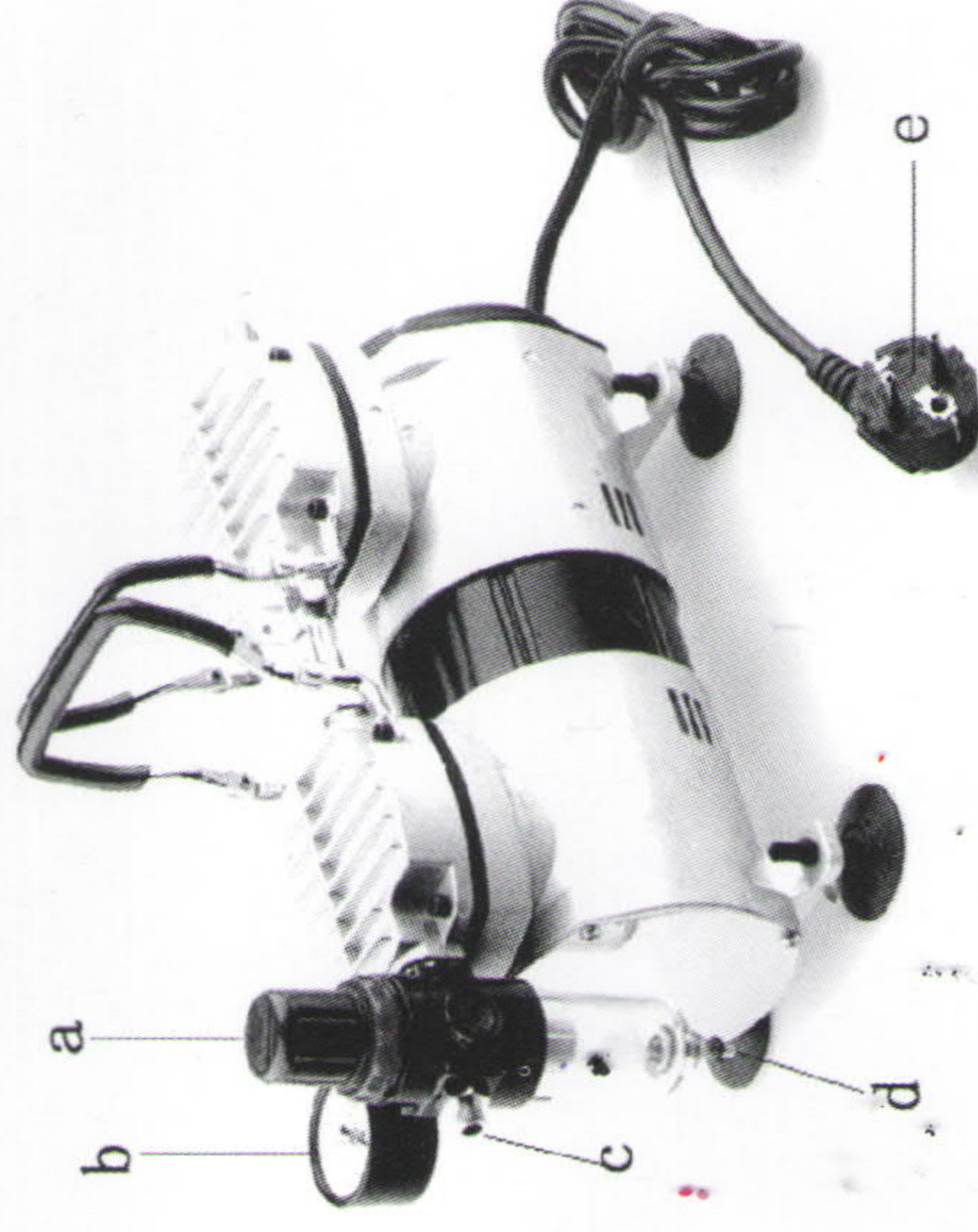

Double switch:

Switch 1: Auto stop at 4 BAR

Switch 2: Max pressure at 6 BAR

a. Pressure regulator

b. Pressure gauge

c. Connection

d. Air filter

f. Power plug